

What Type of Puller do I Want to Use? Will it be the Combination that Works the Best?

Tools to Use

Jaw Type Puller. Two or three jaw style, with three jaw being the best choice. Manual or hydraulic with outside jaw positions.

Push/Pull Puller. Use male or female adaptors to thread into tapped holes on components.

Slide Hammer Puller. Use on light duty applications. For use with attachments.

Bar Type Puller with Bearing Separator. Bar type with side rods threaded into bearing separator provides “knife edge” to get behind component or when there is not a good gripping edge.

Removing a Gear, Bearing, Pulley, or Other Component from a Shaft

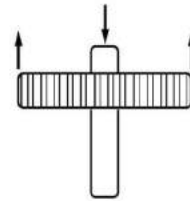

Pulling a Shaft Out of a Housing or Bore

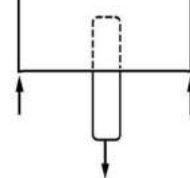

Removing a Bearing or Bushing from a Blind Hole

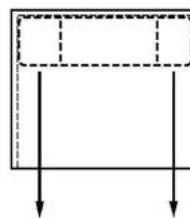

Tools to Use

Push/Pull Puller. Use male or female adaptors.

Bar Type Puller with Bearing Separator. Use when housing lacks sufficient surface for puller side rods to bear against.

Slide Hammer Puller. Use on light duty applications. For use with attachments.

Slide Hammer Puller. Use with male or female adaptors. See this section for a full listing of compatible adaptors.

Tools to Use

Jaw Type Puller. For inside jaw positions (inside pulls), a manual or hydraulic jaw type puller can be used with pressure screw or slide hammer variations.

Expanded Collet Puller. The inside diameter should range between 1/4 and 7". Pulling can be done with bridge, bar type yokes or slide hammers.

Bearing Adaptors with Slide Hammer Puller. CJ127A, CJ128A and CJ137 bearing adaptors with CJ97-3A slide hammer should be used in this application.

Bar Type Puller with Bearing Separator. Bar type with side rods threaded into bearing separator provides “knife edge” to get behind components or when there is not a good gripping edge.

Determine the “Reach” and “Spread” Needed

The puller’s reach must equal or exceed the same distance on the part. The puller’s spread is the width of the part.

Estimate the Puller Tonnage

Generally, if you already have the correct “reach and spread,” you will usually have the proper tonnage. If in doubt, use the next larger size.

General Rule to Choose Pullers

Manual Pullers. Pressure screw should be at least half the diameter of the shaft on the pulling/pushing job.

Hydraulic Pullers. Maximum tonnage capacity (tons) should be 8 to 10 times the diameter (in inches) of the shaft to be pulled or pushed.

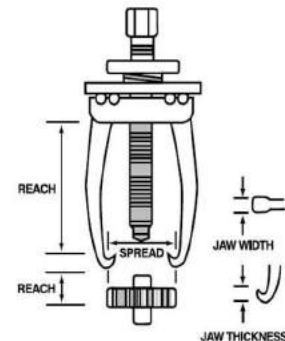

Snap-on® Puller Features

Anvil Head: Curved at the top and features a hex design. The curved head provides a striking surface to handle those tough pulling jobs while the hex allows the pressure screw to be easily turned with a standard hex wrench or a socket.

Spring Loaded Locking Mechanism: Snap-on® pullers feature a unique spring tension locking mechanism which allows the puller jaws to easily lock onto the work surface for both “outside” and “inside” pulling applications.

Two Position Yoke: Allows jaws to be easily reversed to accommodate inside or outside pulling situations. Interchangeable yokes accommodate two and three jaw setups. Yokes are heat treated for additional strength and safety.

One Piece Jaw Construction: Provides a stronger, safer jaw. Most competitive puller jaws have holes drilled through them to allow for a bracket attachment. This hole significantly weakens the competitor’s puller jaws.

Forged Jaws: Resist breakage, prolong tool life and provide additional strength.

Replaceable Points: Center pulling power to prevent cocking. Provide less friction and minimum drag for easier turning of pressure screw during the pulling process. If damage occurs, simply replace the point and not the entire pressure screw.

Curved Jaws: Provide positive grip on the work surface.



• Read safety precautions on pages W1 to W4



PULLERS: BAR-TYPE INTERCHANGEABLE

Bar Type Interchangeable Pullers

Interchangeable bar style pullers provide high quality pulling equipment with the versatility needed to handle a wide variety of pulling functions. Standardized pressure screw threading, jaw retention and design means that new components can be added to an existing puller to change its reach or spread in order to handle new or different applications.

These Snap-on® bar-style pullers also feature:

- Replaceable pressure screw points help keep the puller safely centered
- Multiposition yokes help keep the jaws properly aligned with the item being pulled
- Adjustable clamp bolts allow jaws to be snugged up against the job for a safer, more convenient pull
- Spring ball pin retention securely holds jaws while allowing quick jaw changes



CJ83C

CJ83C Pulley and Gear Puller

- Ideal for servicing crankshaft pulleys, gears and timing gears on a wide range of gasoline and diesel engines including Cummins® accessory drives and water pumps
- Includes (2) 3/8"-16 x 3", 5/16"-18 x 2-1/2" and M10-1.5 x 65 mm bolts
- Nominal capacity is 3-1/2-ton



CJ82B

CJ82B Pitman Arm Pulley

- Handles many pitman arm applications and a wide variety of general pulling jobs
- Nominal capacity is 6 tons



CJ80A

CJ80A A/C Pulley Puller

- Also excellent for removal of alternator, generator, power steering and crankshaft pulleys, harmonic balancers and fiber timing gears
- Includes an extra pair of jaws for versatility
- Nominal capacity is 7-1/2 tons



CJ85A

CJ85A Truck Differential Side Bearing Puller

- Similar in appearance to CJ81D but bigger for handling truck applications
- Four centering plates included
- Nominal capacity is 7-1/2 tons



CJ81D

CJ81D Differential Side Bearing Puller

- Narrow jaws slip into housing grooves in back of bearing and let jaws seat and pull along with inner race
- Jaws are locked onto bearing by clamp bolt
- Four centering plates included
- Nominal capacity is 6 tons

CJ Series Major Components (see chart on next page)

Specifications	CJ80A	CJ81D	CJ82B	CJ83C	CJ85A
Nominal Capacity, tons	7.5	6	6	3.5	7.5
Maximum Reach, inches	D3: 1-5/8, D5: 1-3/8	1-5/8	2-1/4	Variable	1-3/4
Maximum Spread, inches	5	3-3/8	3-3/8	5	5-1/2
Pressure Screw Size, inches	3/4-16 x 3-1/2	3/4-16 x 4-1/4	3/4-16 x 4-1/4	3/4-16 x 3-1/2	3/4-16 x 4-1/4
Optional Jaws	D1, D2, D4	D1, D2, D4, D5	D1, D2, D4, D5	—	D1, D2, D3, D5
Optional Points	C2	C2	C2	C2	C2
Optional Pressure Screws	B1, B2	B1, B3	B1, B3	B1, B2	B1, B3
A Yoke	A3	A4	A4	A4	A3
B, Pressure Screw	B3	B2	B2	B3	B2
C Point	C1	C1	C1	C1	C1
D Jaws (2)	D3, D5	D3	D3	—	D4
E Clamp Bolt	E3	E4	E4	—	E3
F Washers (2)	F1	F1	F1	F2, F3	F1
G Clamp Nuts (2)	G1	G1	G1	—	G1
H Jaw Pins (2)	H1	H1	H1	—	H1
J Adaptors	—	J1	—	—	J2
K Studs (2)	—	—	—	K1, K2, K3	—



PULLERS: BAR-TYPE INTERCHANGEABLE

GENERAL HAND TOOLS



CJ86-1

CJ Interchangeable Pullers— Major Components

A	Component	Key No.	Stock No.	Specific Dimensions		Set Contains:				
				Usable Range, inches	Pin Holes per Side	CJ83C	CJ82B	CJ81D	CJ85A	CJ80A
	Yoke	A1	CJ100-1	10-1/2-16	4					
	Yoke	A2	CJ118-1	6-10-1/2	3					
	Yoke	A3	CJ85-1	3-6-1/2	3				•	•
	Yoke	A4	CJ86-1	1-3/4-4-1/2	2	•	•	•		
				Thread x Length	Hex Size, inches					
	Pressure Screw	B1	CJ105-3	3/4-16 x 10-1/2	7/8					
	Pressure Screw	B2	CJ83-2	3/4-16 x 6-11/16	7/8		•	•	•	•
				Head Dia., inches	Point Type					
	Point	C1	CJ66-15-3	5/8	90° Outward	•	•	•	•	•
				Maximum Reach, inches						
	Jaws (2 needed)	D1	CJ116-1	8-1/4	—					
	Jaws (2 needed)	D2	CJ282-1	4-3/8	—					
	Jaws (2 needed)	D3	CJ81-2A	1-3/8	—		•	•		•
	Jaws (2 needed)	D4	CJ85-2	1-3/4	—				•	
				Maximum Length, inches						
	Clamp Bolts	E1	CJ100A2	18	—					
	Clamp Bolts	E2	CJ118-2A	11-1/2	—					
	Clamp Bolts	E3	CJ85-3A	7-1/2	—				•	•
				Inside Dia., inches	Outside Dia., inches					
	Washer (2 needed)	F1	CJ85-4	15/32	7/8			•	•	•
	Washer (1 needed)	F2	ME5A54	11/32	3/4	•				
	Washer (1 needed)	F3	ME5A55	9/32	3/4	•				
				Thread Size						
Clamp Nuts (2 Needed)	G1	ME4A33	7/16 x 20	—		•	•	•	•	
				Diameter, inches	Length, inches					
Jaw Pins (2 needed)	H1	CJ105-11	5/16	1-15/32		•	•	•	•	
				Outside Dia., inches	Step Diameter, inches					
	Adaptors (Set of 4)	J1	CJ81B1A	1-1/2	1-1/8			•		
			CJ81B2A	1-5/8	1-1/4			•		
			CJ81D1A	1-3/4	1-1/8			•		
			CJ81D2A	1-11/32	15/16			•		
	Adaptors (Set of 4)	J2	CJ85-5	2	1-1/2				•	
			CJ85-6	2-1/8	1-21/32					•
			CJ85-7	2-1/2	1-27/32					•
CJ85-8			3-1/16	2-3/8					•	
				Thread x Length						
	Studs (2 needed)	K1	ME3A44	3/4-16 x 3	—		•			
	Studs (2 needed)	K2	ME3A45	5/16-18 x 2-1/2	—		•			
	Studs (2 needed)	K3	ME3A75	M10-1.5 x 65 mm	—		•			

Letters in chart refer to Key No. in chart below (A3, B1, C1, etc.)



- Screen puller application
- Inspect the puller, do not use damaged parts
- Use the proper type and size puller for the job
- Read safety precautions on pages W1 to W4



PULLERS: BAR-TYPE INTERCHANGEABLE

These puller sets are designed to provide the tools you need as your work grows. Start with one or more sets geared to specific tasks and build toward the ultimate set: the CJ2000A with display board and cabinet. No duplication in set contents or jaws. Yokes are interchangeable for added versatility.



CJ2000A

Master Interchangeable Puller Sets

CJ2000A Master Interchangeable Puller Set

- Includes all components for the CJ2001, CJ2002, CJ2003A, CJ2004 and CJ2005 puller sets
- Same as CJ2000SB without the wall cabinet or the tool control board

CJ2000S Master Interchangeable Puller Set

- Same as the CJ2000SB without the wall cabinet

CJ2000SB Master Interchangeable Puller Set

- Includes all components for the CJ2001, CJ2002, CJ2003A, CJ2004 and CJ2005 puller sets on VE200A tool control board and KRA276D locking wall storage cabinet



CJ2002

Gear Puller Set

CJ2002 Gear Puller Set

- Use on Pitman arms, timing gears, carrier side bearings and more
- Combine to create 10 different pullers
- Capacity from 6–10 tons depending on yoke and jaws used



CJ2004

CJ84-16 Centering Point

CJ83-2 Pressure Screw

CJ85-1 Yoke

Interchangeable Puller Set

CJ2004 Puller Set, Interchangeable

- Use on bearings, bearing races, gears, bushing retainers, etc.
- Builds any of 12 different pullers
- Two- and three-jaw capability with three sets of jaws
- All jaws reverse for inside and outside pulls
- Pulling capacity: (short jaws) 4-1/2 ton, (medium jaws) 6-1/2 ton, (large jaws) 8 ton



CJ2003A

CJ105-10 Short Jaw to Control Pin

Rear Axle Puller Set

CJ2003A Rear Axle Puller Set

- Slide hammer power pulls many flange type rear axles as well as axle bearings
- Set contains CJ123-1 Axle Yoke, ME4A8 Lock Nut (3/4"), CJ127A Bearing Adaptor, CJ66-19 Bearing Hook and CJ128A Bearing Adaptor



Accessory Set

CJ2005 Master Interchangeable Puller Set

- Includes all components for the CJ2001, CJ2002, CJ2003A, CJ2004 and CJ2005 puller sets on VE200A tool control board

CJ81B1A Adaptor

CJ85-5 Adaptor



CJ2005



CJ83-9

Pressure Screws

CJ83-9 Pressure Screw

- Optional pressure screw for bar style interchangeable pullers
- Applications include heavy-duty truck transmissions like Eaton® transmissions found on Kenworth® heavy-duty trucks
- Can also be used with CJ2000A, CJ2000S, CJ2000SB, CJ2002 and CJ2004 puller sets
- Thread: 3/4"-16
- Length: 8-3/4"

CJ86-4A Clamp Bolt

CJ85-3A Clamp Bolt

CJ86-1 Yoke

CJ85-4 Washer

CJ105-11 Long Jaw Pin

CJ87-1 3" Jaw

CJ282-1 6" Jaw

CJ66-15-3 Centering Point

CJ81-2A Jaw

CJ83-3 Pressure Screw

CJ105-6 Medium Jaw

CJ105-11 Long Jaw Pin

CJ105-7 Large Jaw

CJ105-12 Cross Bar

CJ66-15-3 Centering Point

CJ86-1 Yoke

CJ105A8 Three-Way Jaw Control

CJ105-3 Pressure Screw

CJ105A9 Two-Way Jaw Control

CJ105-1 Yoke

CJ105-5 Small Jaw

CJ105-4B Slide Screw

CJ137 Bearing Adaptor

CJ97-3A 3-3/4 lb Slide Hammer

CJ123-1 Axle Yoke

ME4A8 Lock Nut (3/4")

CJ127A Bearing Adaptor

CJ66-19 Bearing Hook

CJ128A Bearing Adaptor

CJ85-6 Adaptor

CJ81B2A Adaptor

CJ85-7 Adaptor

CJ81D1A Adaptor

CJ85-8 Adaptor

CJ81D2A Adaptor

CJ118-1 Yoke, 6–10-1/2"

CJ85-2 Jaw

CJ118-2A Clamp Bolt

CJ Bearing Adaptors

Stock No.	Swivel Head Width, inches	Swivel Head Length, inches	Overall Length, inches
CJ127A	1.2	2.03	3.02
CJ128A	1.2	2.31	3.15
CJ137	1.2	2.9	3.24

PULLERS: AUTOMOTIVE



YA6490A



CJ146



CJ117C



CJ124A



CJ3PSA



CJ147A



CJ122



CJ138



CJ113B

Harmonic Damper Pulley Pullers

YA6490A Harmonic Damper Pulley Puller (Blue-Point®)

- New spring-loaded legs allow for leg position retention
- Provides greater ease and control when installing the puller in confined areas
- Removes harmonic damper pulleys found on many Chrysler® and GM® engines
- Used on autos, pickups, SUVs and vans

CJ146 Crankshaft Harmonic Balancer Kit

- Remove the crankshaft harmonic balancer on 1990 and later 3.3 L and 3.8 L GM® engines
- Shoulder bolt adaptors provide correct installation depth, preventing damage to the crank sensor and interrupter rings

CJ117C Power Steering and Alternator Pulley Puller

- Includes short adaptor to remove small flange-type pulley – use long adaptor on GM® 200/Platform vehicles
- Can also remove Chrysler® alternator pulleys that have double grooves
- Replace pulleys with CJ113B Installer
- Long adaptor included to handle pulleys on GM® minivans
- Nickel/chrome finish, industrial finish screw
- Designed for most US vehicles (replace pulley with CJ122 sets)

CJ147A Power Steering Gear Lower Pinion Bearing Puller

- Required tool to comply with GM® recall bulletins #02049 and #03062 regarding power steering gear lower pinion bearing separation
- To correct the problem, inspect the condition of the lower pinion bearing and replace the lower pinion bearing – in a few cases, replacement of the rack and pinion steering gear assembly may be necessary – instructions included with tool

Power Steering and Alternator Pullers/Single Pullers

CJ122 2 pc Power Steering Pulley Installer Set

- Includes installer and pulley installer shaft
- Thread size of 5/8"-18UNF-2A (puller end) and 3/8" 16UNC-2A (shaft end)

CJ138 Installer, Pulley, M8 x 1.25

- 8 mm pulley installer features a black industrial finish and a thrust bearing for easier installation

- Includes (3) CJ146-1 adaptors, (1) CJ146-2 extension and vinyl storage pouch
- Requires Snap-on® CJ98-1 yoke and CJ83-3 pressure screw for use (not included)

YA13350 Harmonic Damper Pulley Puller (Blue-Point®)

- Use on 3.6L Camaro® engines
- Unique design accesses pulley on internal pulley ledges

YA13450 Harmonic Damper Pulley Puller (Blue-Point®)

- Use on 3.5 L and 5.7 L Dodge® engines
- Unique design accesses pulley on internal pulley ledges

CJ124A Power Steering and Alternator Pulley Puller

- This is a larger version of CJ117C
- Designed for Chrysler®, Ford® and earlier GM® vehicles

CJ3PSA 3 pc Power Steering and Alternator Pulley Removal/Installation Set

- Includes CJ113B, CJ117C, and CJ124A pullers

- Applications: Buick®: Regal® 1996–1998 – Chevrolet®: Cavalier 1996–1998, Lumina 1997–1998, Lumina APV 1996, Malibu® 1997–1998, Monte Carlo® 1997–1998, Venture 1997–1998 – Oldsmobile®: Cutlass 1997–1998, Cutlass Supreme 1996–1998, Silhouette 1996–1998, Intrigue 1998 – Pontiac®: Grand Prix® 1996–1998, Sunfire® 1996–1998, Trans Sport 1996–1998

- Applications: power steering pulley on Ford® 4.6 L V8 (1991 and later), Ford® 2.5 L V6 (1995 and later) and the installation of water pump drive pulleys on GM® 4.6 L (1992 and later Oldsmobile® Aurora)

CJ113B Pulley Installer, Power Steering/Alternator (for domestic vehicles)

- Designed for US vehicles
- 1" pulley driver hex, 7/16" pressure screw hex, thread size of 5/8"-18UNF-2A (puller end) and 3/8" 16UNC-2A (shaft end)
- 4-5/8" long

Bolt Grip Puller Sets

CJ2001P Bolt Grip Puller Set

- Services steering wheels, flywheels, pulleys and gears with tapped holes
- Includes a four-position two- and three-way yoke, three different pressure screw tips and an assortment of SAE and metric bolts
- Approximate spread to bolt is 1-1/4–3-13/16"
- Includes PB54B storage case

CJ2001FBK SAE Bolt and Washer Set

- Replaces all SAE bolts and washers in CJ2001P bolt grip puller set

CJ2001MBK Metric Bolt and Washer Set

- Replaces all metric bolts and washers in CJ2001P bolt grip puller set



CJ2001P

Small Slide Hammer Puller Set

CJ93B Puller Set with Small Slide Hammer

- Removes bushings, seals, sleeves, bearings, bearing races, bronze and oilite bushings and pressed-in studs

- Includes two sets of jaws, grease retainer adaptor, bearing hook, body dent puller, stud-pulling head and 2 lb slide hammer
- Thread size is 3/8-16"



CJ93B

Tapped Hole Bearing Puller Sets

CG60GB 7 pc Tapped Hole Puller Set

- Use on steering wheels with tapped holes
- Includes two- and three-way yoke, pressure screw, adaptor and four sets of studs



CG60GB

Small/Pilot/Ball Bearing Pullers

A78 Small Bearing Puller

- For bearings and bushings typically found in small electric motors
- Includes large jaw set for bronze and oilite bushings – small jaw set for smaller bearings and bushings
- Up to 3-tons of pulling power
- Working range is 1/2–2"

SP2031A Pilot Bearing Puller (Blue-Point®)

- Attaches to slide hammer shafts with 3/4"-16 or 5/8"-18 threads
- Pressure screw adaptor is made of stress-resistant steel
- Industrial finish



A78



SP2031A

AUTOMOTIVE

Steering Wheel Pullers

CJ134 Tilt Steering Pivot Pin Puller

- Allows efficient removal of the two pivot pins on all tilt steering columns used on Chrysler®, Ford® and GM® vehicles



CJ134

CG95B Steering Wheel Lock Plate Remover

- Designed for airbag equipped Saginaw steering columns found on GM®, Chrysler® LH Series (LHS®, Intrepid®, Concorde and Eagle Vision), some Toyota® and Saab® vehicles
- Includes one narrow bridge, one wide bridge, two pressure screws: one has 9/16-18" threads, the other has M14-1.5 threads
- The puller is zinc plated
- Overall length is 4-7/8"



CG95B

CG6095A Steering Wheel Puller Set

- Combines the CG60GB tapped hole puller and CG95B lock plate remover
- Lock plate remover is designed for servicing airbag equipped Saginaw steering columns found on GM®, Chrysler® LH Series (LHS®, Intrepid®, Concorde and Eagle Vision), some Toyota® and Saab® vehicles



CG6095A

CJ145 GM® Steering Wheel Puller

- Use on new GM® steering wheels with air bags including tilting and telescoping styles
- Handle attachment facilitates puller setup and can be removed when working in confined areas
- Applications: Buick® (1997 and later Park Avenue/Regal®), Cadillac® (1997 and later Catera), Chevrolet®/GMC® (1997 and later Corvette®/Malibu®, 1998 C & K series trucks, 1998 full size vans, 1998 Astro/Safari® vans), Oldsmobile® (1997 and later Cutlass) and Pontiac® (1988 1993 LeMans, 1997 and later Grand Prix®/Trans Sport van)



CJ145

CJ131P Steering Wheel Puller and Lock Plate Depressor Set

- Includes a selection of bolts and a handle in storage case for servicing GM®, Ford®, Chrysler® and AMC® vehicles
- Adaptors are included for servicing lock plates on all GM® and AMC® vehicles with tilt wheel
- Detachable handle helps hold puller when turning force is applied to pressure screw
- Industrial finish



CJ131P



- Screen puller application
- Inspect the puller, do not use damaged parts
- Use the proper type and size puller for the job
- Read safety precautions on pages W1 to W4

Pitman Arm Pullers
CJ119B Puller, Pitman Arm (Domestic Cars/Light Trucks)

- Designed for most US cars and light trucks
- Pressure screw size: 3/4"-16 x 6-7/8"
- Industrial finish

CJ115 Pitman Arm Puller

- Similar in design to CJ119B except it is designed for compact and intermediate size cars

PAR1188 Heavy Duty Pitman Arm Puller

- Removal of large pitman arms onto 1 ton pick up trucks

Applications:

- Ford® F-250/350 (2000 and later), Dodge® 2500/3500 (2011 and later), Chevrolet®/GMC® 2500/3500 (2011 and later)

YA6880 Low-Profile Pitman Arm Puller

- Fits in the confined space on most GM® 1988–2000 C and K chassis trucks and SUVs – also fits 2001 present trucks and SUVs with steering gear box/Pitman arms
- Forged chromoly steel for strength and durability
- Design allows the technician to remove the arm off the steering gear box without altering the boxes position as a substantial time saver

PAR1490 Sheppard Pitman Arm Puller

- Fits short sector shaft and long sector shafts with a bolt or nut attachment
- Forged from alloy steel
- Heat treated for rigidity and durability
- Fine pitch thread for reduced effort
- Ball bearing tip to protect the sector shaft

CJ119B

YA6880

PAR1490
GENERAL PURPOSE INTERCHANGEABLE
Light Duty

Builds Pullers.

Stock No.	Puller Type	Maximum Reach, inches (mm)	Outside Spread, inches	Inside Spread, inches
CG240	2-Jaw	2-1/2 (64)	0-3	7/8-3-1/4
CG240H	2-Jaw	2-1/2 (63)	0-3	7/8-3-1/4
CG240HL	2-Jaw	3-1/2 (88)	0-4	1-3-3/4
CG240L	2-Jaw	3-1/2 (89)	0-4	1-3-3/4
CG243	3-Jaw	2-1/2 (64)	0-3	7/8-3-1/4
CG243H	3-Jaw	2-1/2 (64)	0-3	7/8-3-1/4
CG243HL	3-Jaw	3-1/2 (89)	0-4	1-3-3/4
CG243L	3-Jaw	3-1/2 (89)	0-4	1-3-3/4

CG2400B Manual Light Duty Interchangeable General Purpose Puller Set

- This versatile set provides two- or three-jaw pulling with pressure screw or slide hammer options
- Interchange parts to build any of the four puller combinations
- Up to 2-1/2 tons of pulling power
- 3" diameter capacity for outside pulls

CG2400B
Medium Duty

Builds Pullers:

Medium duty pullers deliver up to 7-1/2 tons of pulling power, 4-1/2" diameter capacity for outside pulls

and from 3/4-8" diameter capacity for inside pulls. CG6223 hydraulic conversion set converts CG250 and CG253 manual pullers to hydraulic

power. The manual components of the indicated medium duty pullers are included in the heavy duty (CG2500/CG2510 Series) sets.

Stock No.	Puller Type	Maximum Reach, inches	Outside Spread, inches	Inside Spread, inches
CG250	2-Jaw	3	0-4-1/2	1-1/2-3-1/2
CG250A	2-Jaw, Pulling Plate	3	0-4-1/2	1-1/2-3-1/2
CG250H	2-Jaw	3	0-4-1/2	1-1/2-3-1/2
CG250HL	Long Jaw, 2-Jaw	6	0-8-1/2	3/4-8
CG253	3-Jaw	3	0-4-1/2	1-1/2-3-1/2
CG253H	3-Jaw	3	0-4-1/2	1-1/2-3-1/2
CG253L	3-Jaw	6	0-8-1/2	3/4-8

CG250

- Screen puller application
- Inspect the puller, do not use damaged parts
- Use the proper type and size puller for the job
- Read safety precautions on pages W1 to W4

PULLERS: GENERAL PURPOSE INTERCHANGEABLE



CG2510BSHY



CG2500BSB

Heavy Duty

Builds Pullers:

Stock No.	Puller Type	Maximum Reach, inches	Outside Spread, inches	Inside Spread, inches
CG654HY	Hydraulic, 2-Jaw	3	0-4-1/2	1-1/2-3-1/2
CG655HY	Hydraulic, 3-Jaw	3	0-4-1/2	1-1/2-3-1/2
CG270	2-Jaw	5-1/2	0-8-1/2	2-1/2-7
CG270H	2-Jaw	5-1/2	0-8-1/2	2-1/2-7
CG270S	Special Grip, 2-Jaw	5-1/2	0-8-1/2	2-1/2-7
CG273	3-Jaw	5-1/2	0-8-1/2	2-1/2-7
CG273H	3-Jaw	5-1/2	0-8-1/2	2-1/2-7
CG280	Long Jaw, 2-Jaw	8	0-10	3-8
CG283	Long Jaw, 3-Jaw	8	0-10	3-8
CG274HY	Hydraulic, 2-Jaw	8-3/4	10	3-8
CG275HY	Hydraulic, 3-Jaw	8-3/4	0-10	3-8

The CG2510 and CG2500 Series delivers:

- Up to 12-1/2 tons of pulling power
- 10" diameter capacity for outside pulls
- From 3/4-8" diameter capacity for inside pulls

CG2510BSBHY Heavy-Duty Manual/Hydraulic Interchangeable Puller Set

- Includes 40 interchangeable components, including the CG1224 10-ton hydraulic power kit
- All components are displayed on a VE213 tool control board, which is mounted inside a KRA276D wall cabinet

VE213 Tool Control Board

- Panel for the CG2500BSBHY manual/hydraulic puller set

CG2510BSBHY Heavy-Duty Manual/Hydraulic Interchangeable Puller Set

- Includes 40 interchangeable components, including the CG1224 10-ton hydraulic power kit
- All components are displayed on a VE213 tool control board, which is mounted inside a KRA276D wall cabinet

CG2510BSHY Heavy Duty Interchangeable Manual/Hydraulic Puller Set

- Same as CG2510BSBHY set mounted on a VE213 tool control board
- Does not include the wall cabinet

CG2510BHY Heavy Duty Interchangeable Manual/Hydraulic Puller Set

- Same as CG2510BSBHY set except it does not include either the tool control board or the wall cabinet

CG2500BSB Heavy Duty Interchangeable Manual Puller Set

- This is the CG2510BSBHY set less the 10 ton hydraulic power kit components
- Tool control board for this set is VE113B
- Wall cabinet is KRA276D

VE113B Tool Control Board

- Panel A is designed to hold the components for CG2500BS interchangeable puller set (6, 7-1/2, 10 and 12-1/2 ton capacity)
- Also used as the tool control board for the CG2500BSB manual puller set

CG2500B Heavy-Duty Manual Interchangeable Puller Set

- Same as CG2500BSB set, without the tool control board or the wall cabinet

CG2500BS Heavy-Duty Manual Interchangeable Puller Set

- Same as CG2500BSB set mounted on a VE113B tool control board, without the wall cabinet

PULLERS: 2-JAW PRESSURE SCREW



GENERAL HAND TOOLS

2-ton Capacity (1.8 t), 2 Jaw

Stock No.	Maximum Reach, inches (mm)	Maximum Spread, inches (mm) inside	Maximum Spread, inches (mm) outside	Pressure Screw Size, inches	Jaw Thickness, inches (mm)	Jaw Width, inches (mm)
CG240	2-1/2 (64)	7/8-3-1/4 (22-83)	3 (76)	3/8-16 x 5-1/16	3/16 (5)	3/8 (10)
CG240L	3-1/2 (89)	7/8-3-3/4 (25-95)	4 (102)	3/8-16 x 6-1/16	3/16 (5)	3/8 (10)



CG240

6-ton Capacity (5.4 t), 2-Jaw

Stock No.	Maximum Reach, inches (mm)	Maximum Spread, inches (mm) inside	Maximum Spread, inches (mm) outside	Pressure Screw Size, inches	Jaw Thickness, inches (mm)	Jaw Width, inches (mm)
CG250	3 (76)	1-1/2-3-1/2 (38-89)	4-1/2 (114)	5/8-18 x 6-7/8	1/4 (6)	3/4 (19)
CG250A*	3 (76)	1-1/2-3-1/2 (38-89)	4-1/2 (114)	5/8-18 x 6-7/8	1/4 (6)	3/4 (19)



CG250

10-ton Capacity (9.1 t), 2-Jaw

Stock No.	Maximum Reach, inches (mm)	Maximum Spread, inches (mm) inside	Maximum Spread, inches (mm) outside	Pressure Screw Size, inches	Jaw Thickness, inches (mm)	Jaw Width, inches (mm)
CG270	5-1/2 (140)	2-1/2-7-1/2 (64-178)	8-1/2 (216)	3/4-16 x 9-13/16	1/4 (6)	15/16 (24)
CG270A*	5-1/2 (140)	2-1/2-7-1/2 (64-178)	8-1/2 (216)	3/4-16 x 9-13/16	1/4 (6)	15/16 (24)
CG272**	5-1/2 (140), 8-3/4 (222)	2-1/2-7-1/2 (64-178), 3-8 (76-203)	8-1/2 (216), 10 (254)	3/4-16 x 9-13/16, 3/4-16 x 12-1/8	1/4 (6)	15/16 (24)
CG270S	5-1/2 (140)	2-1/2-7-1/2 (64-178)	8-1/2 (216)	3/4-16 x 9-13/16	1/4 (6)	15/16 (24)
CG280	8-3/4 (222)	3-8 (76-203)	10 (254)	3/4-16 x 12-1/8	1/4 (6)	15/16 (24)
CG284***	15 (381)	4-3/4-11-1/2 (121-292)	13-3/4 (349)	3/4-16 x 18-15/16	3/8 (10)	1 (25)



CG270A



CG280

*Includes CG1 pulling plate. **Two jaw lengths. ***Includes pressure screw extension.

3-JAW PRESSURE SCREW

2-1/2-ton Capacity (2.3 t), 3-Jaw

Stock No.	Maximum Reach, inches (mm)	Maximum Spread, inches (mm) inside	Maximum Spread, inches (mm) outside	Pressure Screw Size, inches	Jaw Thickness, inches (mm)	Jaw Width, inches (mm)
CG243	2-1/2 (64)	7/8-3-1/4 (22-83)	3 (76)	3/8-16 x 5-1/16	3/16 (5)	3/8 (10)
CG243L	3-1/2 (89)	7/8-3-3/4 (22-95)	4 (102)	3/8-16 x 6-1/16	3/16 (5)	3/8 (10)



CG243

6-ton Capacity (5.4 t), 3-Jaw

Stock No.	Maximum Reach, inches (mm)	Maximum Spread, inches (mm) inside	Maximum Spread, inches (mm) outside	Pressure Screw Size, inches	Jaw Thickness, inches (mm)	Jaw Width, inches (mm)
CG253L	6 (152)	3/4-8 (19-203)	5/8-18 x 6-7/8	5/8-18 x 6-7/8	5/16 (8)	3/8 (10)



CG253L

7-1/2-ton Capacity (6.8 t), 3-Jaw

Stock No.	Maximum Reach, inches (mm)	Maximum Spread, inches (mm) inside	Maximum Spread, inches (mm) outside	Pressure Screw Size, inches	Jaw Thickness, inches (mm)	Jaw Width, inches (mm)
CG253	3 (76)	1-1/2-3-1/2 (38-89)	4-1/2 (114)	5/8-18 x 6-7/8	1/4 (6)	3/4 (19)



CG285

12-1/2-ton Capacity (11.3 t), 3-Jaw

Stock No.	Maximum Reach, inches (mm)	Maximum Spread, inches (mm) inside	Maximum Spread, inches (mm) outside	Pressure Screw Size, inches	Jaw Thickness, inches (mm)	Jaw Width, inches (mm)
CG273	5-1/2 (140)	2-1/2-7-1/2 (64-178)	8-1/2 (216)	3/4-16 x 9-13/16	1/4 (6)	15/16 (24)
CG273A	5-1/2 (140)	2-1/2-7-1/2 (64-178)	8-1/2 (216)	3/4-16 x 9-13/16	1/4 (6)	15/16 (24)
CG283	8 (203)	3-8 (76-203)	10 (254)	3/4-16 x 12-1/8	1/4 (6)	15/16 (24)
CG285	15 (381)	4-3/4-11-1/2 (121-292)	13-3/4 (349)	3/4-16 x 18-15/16	3/8 (10)	1 (25)

Pulling Plate

CG1 Pulling Plate

- Ideal where there is no gripping surface for the puller alone
- Attach plate to item being pulled – puller clamps behind the plate
- Includes four each of the following screws: 1/4"-20 x 3/4" and 1/4"-28 x 1"
- Plate has a 3-5/8" diameter

Flat Points

CG270-21 Flat Point

- Fits CG270 and CG280 series pullers

CG300-21 Flat Point

- Fits CG300 and CG305 series pullers

CG325-21 Flat Point

- Fits CG325 series pullers

CG70 3 pc Flat Point Set

- Includes (3) flat points



CG1

- Screen the puller application
- Inspect the puller, do not use damaged parts
- Use the proper type and size puller for the job
- Read safety precautions on pages W1 to W4



PULLERS: 2-JAW SLIDE HAMMER



CG240H

2-ton Capacity (1.8 t) – 1-1/16 lb Hammer

Stock No.	Maximum Reach, inches (mm)	Maximum Spread, inches (mm) inside	Maximum Spread, inches (mm) outside	Slide Screw Size, inches	Jaw Thickness, inches (mm)	Jaw Width, inches (mm)
CG240H	2-1/2 (63)	7/8–3-1/4 (22–82)	3 (76)	3/8–16 x 12-5/8	3/16 (5)	3/8 (10)
CG240HL	3-1/2 (88)	7/8–3-3/4 (25–95)	4 (102)	3/8–16 x 12-5/8	3/16 (5)	3/8 (10)



CG250HL

6-ton Capacity (5.4 t) – 2-1/8 lb Hammer

Stock No.	Maximum Reach, inches (mm)	Maximum Spread, inches (mm) inside	Maximum Spread, inches (mm) outside	Slide Screw Size, inches	Jaw Thickness, inches (mm)	Jaw Width, inches (mm)
CG250C*	3 (76)	1-1/2–3-1/2 (38–89)	4-1/2 (114)	5/8–18 x 18-1/16	1/4 (6)	3/4 (19)
CG250H	3 (76)	1-1/2–3-1/2 (38–89)	4-1/2 (114)	5/8–18 x 18-1/16	1/4 (6)	3/4 (19)
CG250HL	6 (152)	3/4–8 (19–203)	—	5/8–18 x 18-9/16	7/32 (5)	5/16 (8)

*Includes CG250H puller, CG1 pulling plate and pressure screw



CG270C

10-ton Capacity (9.1 t) – 3-1/2 lb Hammer

Stock No.	Maximum Reach, inches (mm)	Maximum Spread, inches (mm) inside	Maximum Spread, inches (mm) outside	Slide Screw Size, inches	Jaw Thickness, inches (mm)	Jaw Width, inches (mm)
CG270C**	5-1/2 (140)	2-1/2–7-1/2 (64–178)	8-1/2 (216)	3/4–16 x 23-3/8	1/4 (6)	15/16 (24)
CG270H	5-1/2 (140)	2-1/2–7-1/2 (64–178)	8-1/2 (216)	3/4–16 x 23-3/8	1/4 (6)	15/16 (24)

**Includes CG1 pulling plate and pressure screw

PULLERS: 3-JAW SLIDE HAMMER



CG243H

2-1/2-ton Capacity (2.3 t) – 1-1/16 lb Hammer

Stock No.	Maximum Reach, inches (mm)	Maximum Spread, inches (mm) inside	Maximum Spread, inches (mm) outside	Slide Screw Size, inches	Jaw Thickness, inches (mm)	Jaw Width, inches (mm)
CG243H	2-1/2 (64)	7/8–3-1/4 (22–83)	3 (76)	3/8–16 x 12-5/8	3/16 (5)	3/8 (10)
CG243HL	3-1/2 (89)	7/8–3-3/4 (25–95)	4 (102)	3/8–16 x 12-5/8	3/16 (5)	3/16 (5)



CG253H

7-1/2-ton Capacity (6.8 t) – 2-1/8 lb Hammer

Stock No.	Maximum Reach, inches (mm)	Maximum Spread, inches (mm) inside	Maximum Spread, inches (mm) outside	Slide Screw Size, inches	Jaw Thickness, inches (mm)	Jaw Width, inches (mm)
CG253H	3 (76)	1-1/2–3-1/2 (38–89)	4-1/2 (114)	5/8–18 x 18-1/16	1/4 (6)	3/4 (19)



CG273C

12-1/2-ton Capacity (11.3 t) – 3-1/2 lb Hammer

Stock No.	Maximum Reach, inches (mm)	Maximum Spread, inches (mm) inside	Maximum Spread, inches (mm) outside	Slide Screw Size, inches	Jaw Thickness, inches (mm)	Jaw Width, inches (mm)
CG273C*	5-1/2 (140)	2-1/2–7-1/2 (64–178)	8-1/2 (216)	3/4–16 x 23-3/8	1/4 (6)	15/16 (24)
CG273H	5-1/2 (140)	2-1/2–7-1/2 (64–178)	8-1/2 (216)	3/4–16 x 23-3/8	1/4 (6)	15/16 (24)

*Includes CG273H puller, CG1 pulling plate and pressure screw

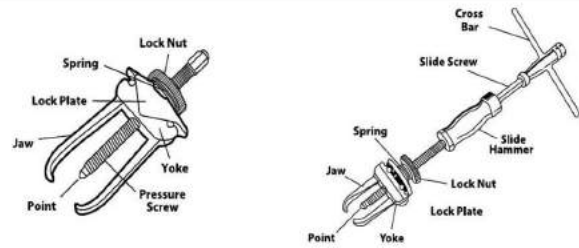

2-1/2-ton Capacity (2.3 t) – 1-1/16 lb Hammer

Stock No.	2-Jaw Yoke CG240-2	3-Jaw Yoke CG243-2	Std. Pres. Screw CG240-1	Long Pres. Screw CG240-11	Slide Screw CG240-8	Slide Hammer CG240-9	2-Jaw Lock Plate CG240-5	3-Jaw Lock Plate CG243-5	Spring CG240-6	Adjusting Nut CG240-7	Standard Jaw CG240-3	Long Jaw CG240-10
CG240	1	—	1	—	—	—	1	—	1	1	2	—
CG240L	1	—	—	1	—	—	1	—	1	1	—	2
CG240H	1	—	—	—	1	1	1	—	1	1	2	—
CG240HL	1	—	—	—	1	1	—	—	1	1	—	2
CG243	—	1	1	—	—	—	1	1	1	1	3	—
CG243L	—	1	—	1	—	—	—	1	1	1	—	3
CG243H	—	1	—	—	1	1	—	1	1	1	3	—
CG243HL	—	1	—	—	1	1	—	1	1	1	—	3

6-ton Capacity (5.4 t) – 2-1/8 lb Hammer

Stock No.	2-Jaw Yoke CG250-2	3-Jaw Yoke CG253-2	Pressure* Screw CG250-1A	Slide* Screw CG250-8A	Slide Hammer CG250-9	Cross Bar CG10F	Lock Plate CG250-5	Spring CG250-6	Adjusting Nut CG250-7	Standard Jaw CG250-3	Long Jaw CG250-10	Pulling Plate CG1
CG250	1	—	1	—	—	—	1	1	1	2	—	—
CG250A	1	—	1	—	—	—	1	1	1	2	—	1
CG250C	1	—	1	1	1	1	1	1	1	2	—	1
CG250H	1	—	—	1	1	1	1	1	1	2	—	—
CG250HL	1	—	—	1	1	1	1	1	1	—	2	—
CG253	—	1	1	—	—	—	1	1	1	3	—	—
CG253H	—	1	—	1	1	1	1	1	1	3	—	—
CG253L	—	1	1	—	—	—	1	1	1	—	3	—
CG2500B**	1	1	1	1	1	1	2	2	2	3	3	—

**CG2500B continued in next chart

CG2500B Heavy-Duty Manual Interchangeable Puller Set

- Same as CG2500BSB set, without the tool control board or the wall cabinet

Heavy Duty

Stock No.	2-Jaw Yoke CG270-2	3-Jaw Yoke CG273-2	Std. Pres.* Screw CG270-1A	Long Pres.* Screw CG270-11A	Manual Adaptor CG270-13	Slide* Screw CG270-8A	Slide Hammer CG66-2	2-Jaw Lock Plate CG270-5	3-Jaw Lock Plate CG273-5	Spring CG270-6	Lock Nut CG270-7	Standard Jaw CG270-3	Long Jaw CG270-10	Special Jaw CG270-3S	Extra Long Jaw CG270-12
CG270	1	—	1	—	—	—	—	—	—	1	1	2	—	—	—
CG270A	1	—	1	—	—	—	—	—	—	1	1	2	—	—	—
CG270C	1	—	1	—	—	1	1	—	—	1	1	2	—	—	—
CG270H	1	—	—	—	—	1	1	—	—	1	1	2	—	—	—
CG270S	1	—	1	—	—	—	—	1	—	1	1	—	—	2	—
CG272	1	—	—	1	—	—	—	1	—	1	1	—	2	—	—
CG273A	—	1	1	—	—	—	—	—	1	1	1	3	—	—	—
CG273C	—	1	1	—	—	1	1	—	—	1	1	3	—	—	—
CG273H	—	1	—	—	—	1	1	—	1	1	1	3	—	—	—
CG280	1	—	—	1	—	—	—	—	—	1	1	—	2	—	—
CG283	—	1	—	1	—	—	—	—	1	1	1	—	3	—	—
CG284	1	—	—	1	1	—	—	—	—	1	1	—	—	—	2
CG285	—	—	—	1	1	—	—	—	1	1	1	—	—	—	3
CG2500B	—	—	—	—	—	—	—	—	—	—	—	—	—	—	—

20-ton Capacity (18.1 t), 2-Jaw

Stock No.	Description	2-Jaw Yoke CG300-2	Lock Nut CG300-7	Lock Plate CG300-5	Long Jaw CG305-9	Pressure Screw CG300-1	Pressure Screw CG305-8	Spring CG300-6	Standard Jaw CG300-3
CG300	20 Ton Two Jaw Pressure Screw Puller	1	1	1	—	1	—	1	2
CG305	20 Ton Two Jaw Pressure Screw Puller	1	1	1	2	—	1	1	—



- Screen the puller application
- Inspect the puller, do not use damaged parts
- Use the proper type and size puller for the job
- Read safety precautions on pages W1 to W4

PULLERS: INDUSTRIAL



CG1038KA

Industrial Puller Sets

CG1038KA Industrial Puller Set

- Includes more than 35 basic pullers that will assemble into more than 165 puller combinations
- Standard pullers in this set have a range from 2–20-tons
- The hydraulic power components provide up to 20-tons of easy pulling power
- Optional 10 and 50-ton hydraulic accessories are available
- Components are mounted on (4) 24 x 32 x 3/4" tool control panels (labeled A, B, C and D) with white silhouettes
- The panels are mounted on KRA213E A-frame

CG1050KA Expanded Industrial Puller Set

- Includes CG1038KA industrial puller set and the CG1224 power kit for converting 10-ton manual pullers to hydraulic power; CG300-1, CG305-8 and CG350-1 pressure screws; CG343-1 4" plug; CG350-2 manual yoke for converting the 20-ton hydraulic pullers to manual power and CG555 basic hydraulic set for building a 50-ton hydraulic bar type puller
- Includes CG420-5C pressure gauge, CG420-6 gauge mounting adaptor, ten CG250-20 small centering adaptors and ten CG270-20 large centering adaptors

KRA213E A-Frame

- Mobile unit features 23,220 in³, 1,260 in² of storage for convenient access and orderly storage
- Measures 26-1/2 x 52-3/8 x 32-3/8"

Tool Control Boards

VE113B Tool Control Board

- Panel A is designed to hold the components for CG2500BS interchangeable puller set (6, 7-1/2, 10 and 12-1/2 ton capacity)
- Also used as the tool control board for the CG2500BSB manual puller set

CG250 6 Ton Two Jaw Pressure Screw Puller**CG250H 6 Ton Two Jaw Slide Hammer Puller****CG250HL 6 Ton Two Jaw Slide Hammer Puller****CG253 7-1/2 Ton Three Jaw Pressure Screw Puller****CG253H Three Jaw Medium Duty Puller****CG270 10 Ton Two Jaw Pressure Screw Puller****CG270H 10 Ton Two Jaw Slide Hammer Puller****CG270S 10 Ton Two Jaw Pressure Screw Puller****CG273 12-1/2 Ton Three Jaw Pressure Screw Puller****CG273H 12-1/2 Ton Three Jaw Slide Hammer Puller****CG280 10 Ton Two Jaw Pressure Screw Puller****CG283 12-1/2 Ton Three Jaw Pressure Screw Puller****VE138-3B Tool Control Board**

- Panel B is designed to hold CG2400 light duty puller set, CJ840C tapped hole puller set, CJ949 bearing separator and CJ9500 bearing separator set components

CG240 2 Ton Two Jaw Pressure Screw Puller**CG240H 2 Ton Two Jaw Slide Hammer Puller****CG243 2-1/2 Ton Three Jaw Pressure Screw Puller****CG243H 2-1/2 Ton Three Jaw Slide Hammer Puller****CJ93B Puller Set with Small Slide Hammer****CJ840C Complete Bar-Type Manual Tapped Hole Puller Set****CJ949 1-1/8" Bearing Separator****CJ950 2-3/8" Bearing Separator****CJ951 4-1/2" Bearing Separator****CJ952 6-1/8" Bearing Separator****VE138-2B Tool Control Board**

- Panel C is designed to hold CG450HYA 20 ton hydraulic bar type puller components and the components of CG2545AB blind hole bearing puller set

CG45 7 pc Blind Hole Bearing Puller Set**CG450 Bar-Type Manual Puller Set****CG450HYA Bar-Type Hydraulic/Manual Puller Set****VE138-1B Tool Control Board**

- Panel D is designed to hold components of CG400 20 ton jaw type puller, three CG305-9 long jaws, CG455 and CG455A threaded adaptor sets, plus CG455-18 and CG455-19 pressure screw adaptors
- The adaptors are for use with the bar-type pullers on tool control panel C

CG400 Manual Combination Two and Three Jaw Puller**CG400HYA 20-Ton Hydraulic Puller****CG405 Manual Combination Two and Three Jaw Puller****CG405HYA 20-Ton Hydraulic Puller**

Pump and Ram Set Components

Features of Two Stage Hydraulic Pumps

- Two stage design will advance 20–50 ton rams in the low pressure stage in less than 1/3 the strokes required on other models
- CG520 Ram extends in 60–70 strokes
- CG420 Ram extends in 17–19 strokes
- When high pressure is required, the low-pressure stage automatically kicks out to leave the high-pressure stage to do the work



Capacity, tons	Stock No.	Stroke, inches	Collapsed Height, inches	Extended Height, inches	Effective Area (piston)	Oil Capacity (in ³)	Pressure Screw Size, inches
4	CG220	2-1/4	6	8-1/4	.966	2.174	1/2–13 x 14-1/4
6	CG650	1-1/2	4-11/16	6-3/16	1.473	2.210	5/8–11 x 13-1/4
10	CG120	1	4-3/4	5-3/4	2.440	2.440	3/4–10 x 16-1/4
20	CG420-1A	2	6	8	4.418	8.836	1-1/8–8 x 20-1/2
35	CG720	2-1/2	7	9-1/2	7.903	19.758	1-3/8–8 x 25
50	CG520	3	8-1/8	11-1/8	11.066	33.198	1-5/8–5-1/2 x 30

CG222 4-Ton Hydraulic Pump and Ram Set

Includes:

- CG4-2A Single Stage Pump
- CG120-3-1 Hydraulic Hose
- CG120-4 Coupler Set
- CG220 4 Ton Hydraulic Ram
- CG220-13 Pressure Screw
- CG4-2A Single Stage Pump

CG122 10-Ton Hydraulic Pump and Ram Set

Includes:

- CG120 Ram, Hydraulic, 10-Ton
- CG4-2A Single Stage Pump
- CG120-13 Pressure Screw
- CG120-3-1 Hydraulic Hose
- CG120-4 Coupler Set



CG652 6-Ton Hydraulic Pump and Ram Set

Includes:

- CG120-3-1 Hydraulic Hose
- CG120-4 Coupler Set
- CG250-20 Replacement for CG250 Series Point
- CG4-2A Single Stage Pump
- CG650 6-Ton Ram

CG420A 20-Ton Hydraulic Pump and Ram Set

Includes:

- CG420-1A 20-Ton Ram
- CG420-2A Single Stage Hydraulic Pump
- CG420-1-14 Centering Adaptor
- CG420-3-1 Hose
- CG420-4 Coupler Set
- CG420A25 Hydraulic Pump and Ram Set



HYDRAULIC ACCESSORIES

CG6223 Hydraulic Conversion Power Kit

- 6 ton
- Converts CG250, CG253 manual pullers and CG1500 puller set to hydraulic power
- Includes 6 ton pump and ram set, two jaw yoke, hand wheel adaptor and three jaw yoke

CG652 6-Ton Hydraulic Pump and Ram Set

CG250-15 6-Ton Yoke

CG250-16 Hand Wheel Adaptor

CG253-15 6-Ton Yoke

CG1224 10-Ton Hydraulic Conversion Kit

- Converts CG270, CG273, CG280, and CG283 manual pullers (on tool control panel A) and CG1700/CG2500B puller sets to hydraulic power

CG122 10-Ton Hydraulic Pump and Ram Set

CG270-15 10-Ton Yoke

CG270-16 Hand Wheel Adaptor

CG273-15 10-Ton Yoke

CG558 50 Ton Hydraulic Push-Pull Puller Accessory Set

- Includes additional side rods and end blocks, plus work screw, side rod, and bull nose adaptors to increase the versatility of the CG555 Basic Hydraulic Set



CG420-5C Pressure Gauge

- Can be used with 6, 10, 20, 35 and 50-ton hydraulic equipment
- Use for CG4-2A, CG420-2A and CG420A-2S hydraulic pumps
- Indicates hydraulic pressure in ton of pressure as well as PSI
- Adaptor CG420-6 is required to attach gauge to pumps

CG420-6 Gauge Mounting Adaptor

- Mounts CG420-5C pressure gauge to 6, 10, 20, 35 and 50 ton hydraulic systems



- Screen the puller application
- Inspect the puller, do not use damaged parts
- Use the proper type and size puller for the job
- Read safety precautions on pages W1 to W4

PULLERS: 2-AND 3-JAW HYDRAULIC



Heavy Duty

Stock No.	Maximum Reach, inches (mm)	Maximum Spread, inches (mm) inside	Maximum Spread, inches (mm) outside	Pressure Screw Size, inches	Jaw Thickness, inches (mm)	Jaw Width, inches (mm)
CG654HY+ Hydraulic, 2 Jaw	3 (76)	1-1/2-3-1/2 (38-89)	4-1/2 (114)	5/8-11 x 13-3/4	1/4 (6)	3/4 (19)
CG655HY* Hydraulic, 3 Jaw	3 (76)	1-1/2-3-1/2 (38-89)	4-1/2 (114)	5/8-11 x 13-3/4	1/4 (6)	3/4 (19)

†Includes hydraulic ram and pump set.

*To convert to manual power, use pressure screw, adjusting nut and yoke from either CG250 or CG253 Pullers.



10-ton Capacity (9.1 t)

Stock No.	Maximum Reach, inches (mm)	Maximum Spread, inches (mm) inside	Maximum Spread, inches (mm) outside	Pressure Screw Size, inches	Jaw Thickness, inches (mm)	Jaw Width, inches (mm)
CG274HY+ 2 Jaw Model	8-3/4 (222)	3-8 (76-203)	3-8 (76-203), 10-1/2 (266)	3/4-10 x 16-1/4	1/4 (6)	15/16 (24)
CG275HY+ 3 Jaw Model	8-3/4 (222)	3-8 (76-203)	10 (254)	3/4-10 x 16-1/4	1/4 (6)	15/16 (24)
CG276HY+ 2 Jaw Model	15 (381)	4-3/4-11-1/2 (121-292)	13-3/4 (349)	3/4-10 x 23-3/8	3/8 (9)	1 (25)
CG277HY* 3 Jaw Model	15 (381)	4-3/4-11-1/2 (121-292)	13-3/4 (349)	3/4-10 x 23-3/8	3/8 (9)	1 (25)

†Includes hydraulic ram and pump set.

*To convert to manual power, use pressure screw, adjusting nut and yoke from either CG270 or CG273 Pullers.



20-ton Capacity (18.1 t) Combination 2 and 3 Jaw

Stock No.	Maximum Reach, inches (mm)	Maximum Spread, inches (mm) outside	Pressure Screw Size, inches	Jaw Thickness, inches (mm)	Jaw Width, inches (mm)
CG400HYA*	9-1/2 (241)	13 (330)	1-1/8-8 x 20-1/2	7/16 (11)	1-1/4 (32)
CG400	CG400HYA less hydraulic ram and pump				
CG343	Manual version of CG400HYA. Includes CG343-1 4" Plug and CG300-1 1-14 Pressure Screw in place of ram and pump				
CG405HYA*	14 (355)	15 (381)	1-1/8-8 x 20-1/2	9/16 (14)	1-1/4 (32)
CG405	CG405HYA less hydraulic ram and pump				
CG348	Manual version of CG405HYA. Includes CG343-1 4" Plug and CG305-8 1-14 Pressure Screw in place of ram and pump				
CG425HYA*	19 (482)	20 (508)	1-1/8-8 x 20-1/2	1-1/8 (29)	1-1/2 (38)
CG425	CG425HYA less hydraulic ram and pump				
CG325	Manual version of CG425HYA. Includes 1-3/8"-8 x 20-11/16" pressure screw in place of pump, ram, washer adaptor, ram adaptor and cap screws				

*Included with hydraulic ram.



50-ton Capacity (45.36 t) Combination 2 and 3 Jaw

Stock No.	Maximum Reach, inches (mm)	Maximum Spread, inches (mm) outside	Pressure Screw Size, inches	Jaw Thickness, inches (mm)	Jaw Width, inches (mm)
CG560HY*	28 (711)	44 (1,118)	1-5/8-5-1/2 x 30	1-7/16 (36)	2 (51)

*Included with hydraulic ram

PULLERS: BAR-TYPE MANUAL TAPPED HOLE SETS



6-ton Capacity (5.41 t), Tapped Hole

Stock No.	Maximum Reach, inches (mm)	Maximum Spread, inches (mm)	Pressure Screw	Side Rods (2)	Side Rod Adaptors (2)
CJ840C	33 (838)	2-5/8-11-5/8 (67-295)	1-14 x 30	5/8-18	1/2-20, 1/2-13, 3/4-16, 3/4-10
Complete Puller Set	Side rods in set are provided two each in 5" (CJ84-5), 10" (CJ84A2) and 20" (CJ84-3) lengths			3/8"-24, 3/8"-16, 5/16"-24, 5/16"-18, 7/16"-20, 5/8"-18, 5/8"-11, 7/16"-14	
CJ84C	33 (838)		1-14 x 33	5/8-18	
Basic Puller Set		2-5/8-11-5/8			1/2"-20, 1/2"-13, 5/8"-18, 5/8"-11, 3/4"-16, 3/4"-10

6-ton Capacity (5.4 t), Push-Pull

Stock No.	Maximum Reach, inches (mm)	Maximum Spread, inches (mm)	Pressure Screw Size, inches	Pressure Screw Adaptor	Side Rods	Side Rod Adaptors
CG706 Push/Pull Set	14-1/8 (358)	2-5/8-7-1/2 (67-191)	5/8-18 x 10	—	7/16-14 x 8 (4 each)	7/16-14f x 5/8-18m

CG706
10-ton Capacity (9.1 t), Push-Pull

Stock No.	Maximum Reach, inches (mm)	Maximum Spread, inches (mm)	Pressure Screw Size, inches	Pressure Screw Adaptor	Side Rods
CG710 Push/Pull Set	17-5/8 (448)	3-9/16-9-3/8 (90-238)	3/4-16 x 12	CG710-3 3/4-16f x 5/8-18m	(2) 5/8-18 x 8, (2) 5/8-18 x 12

CG710
BAR-TYPE HYDRAULIC/MANUAL SETS
6-ton Capacity (5.4 t), Hydraulic

Stock No.	Maximum Reach, inches (mm)	Maximum Spread, inches (mm)	Pressure Screw Size, inches	Pressure Screw Adaptor	Side Rods	Side Rod Adaptors
CG656HY* Hydraulic Set	14-1/8 (358)	2-5/8-7-1/2 (67-191)	5/8-11 x 13-3/4	5/8-11f x 5/8-18m	7/16-14 x 8	7/16-14f x 5/8-18m
CG656	CG656HY Set less the hydraulic components					

*Included with hydraulic ram

10-ton Capacity (9.1 t), Hydraulic

Stock No.	Maximum Reach, inches (mm)	Maximum Spread, inches (mm)	Pressure Screw Size, inches	Pressure Screw Adaptor	Side Rods	Side Rod Adaptors
CG150HY Hydraulic Set	17-5/8 (448)	3-9/16-9-3/8 (90-238)	3/4-10 x 16-1/4	3/4-10f x 5/8-18m, 3/4-10f x 3/4-16m	5/8-18 x 8, 5/8-18 x 12	—
CG150	CG150HY Set less the hydraulic components					

CG150HY
20-ton Capacity (18.1 t), Hydraulic

Stock No.	Maximum Reach, inches (mm)	Maximum Spread, inches (mm)	Pressure Screw Size, inches	Pressure Screw Adaptor	Side Rods, inches	Side Ride Adaptors, inches
CG450HYA Hydraulic Set	24 (610)	6-15 (152-381)	1-1/8-8 x 20-1/2	—	7/8-14 x 20, 7/8-14 x 10	7/8-14f x 7/8-14m, 7/8-14f x 5/8-18m
CG450	CG450HY Set less the hydraulic components					
CG350	Manually operated version of the CG450					

*Included with hydraulic ram

CG450HYA
35-ton Capacity (31.7 t), Hydraulic

Stock No.	Maximum Reach, inches (mm)	Maximum Spread, inches (mm)	Pressure Screw Size, inches	Pressure Screw Adaptor	Side Rods	Side Rod Adaptors
CG750HY	26 (660)	8-1/2-17 (216-432)	1-3/8-8 x 25	1-3/8-8f x 7/8-14m	1-14 x 20, 1-14 x 10	1-14f x 7/8-14m, 7/8-14f x 3/4-16m
CG750	CG750HY Set less the hydraulic components					



CG750HY

- Screen the puller application
- Inspect the puller, do not use damaged parts
- Use the proper type and size puller for the job
- Read safety precautions on pages W1 to W4

PULLERS: REFERENCE CHARTS

GENERAL HAND TOOLS

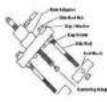
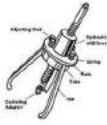
Heavy Duty



Stock No.	Hydraulic Unit	Ram Adaptor	Hydraulic Adaptor	Yoke	Pressure Screw	4" Dia. Plug	Plate	Spring	Adj. Stud	Jaws	Side Arms/Side Plate	Arm Bolts Arm Nuts	Washers/Cap Screws
CG654HY	CG652	CG250-16	—	CG250-15	—	—	CG250-5	CG250-6	—	CG250-3 (2)	—	—	—
CG655HY	CG652	CG250-16	—	CG253-15	—	—	CG250-5	CG250-6	—	CG250-3 (3)	—	—	—
CG274HY	CG122	CG270-16	—	CG270-15	—	—	CG270-5	CG270-6	—	CG270-3 (2)	—	—	—
CG275HY	CG122	CG270-16	—	CG273-15	—	—	CG273-5	CG270-6	—	CG270-10 (3), CG270-3 (3)	—	—	—
CG276HY	CG122	CG270-16	CG270-14	CG270-15	—	—	CG270-5	CG270-6 (4)	—	CG270-12 (2)	—	—	—
CG277HY	CG122	CG270-16	CG270-14	CG273-15	—	—	CG273-5	CG270-6 (4)	—	CG270-12 (3)	—	—	—
CG400HYA	CG420A	—	—	CG400-2	—	—	CG400-5	CG400-6 (4)	CG400-7 (4)	CG300-3 (3)	—	—	—
CG343	—	—	—	CG400-2	CG300-1	—	CG400-5	CG400-7 (4)	CG300-3 (3)	—	—	—	—
CG405HYA	CG420A	—	—	CG400-2	—	—	CG400-5	CG400-6 (4)	CG400-7 (4)	CG305-9 (3)	—	—	—
CG348	—	—	—	CG400-2	CG305-8	—	CG400-5	CG400-7 (4)	CG305-9 (3)	—	—	—	—
CG425HYA	CG420A	CG425-9	—	CG325-2	—	—	—	—	—	CG325-3 (3)	CG325-4 (3)	CG325-5 (3)	CG425-7
CG325	—	—	—	CG325-2	CG325-1	—	—	—	CG325-3 (3)	CG325-4 (3)	CG325-5 (3)	—	—
CG560HY	CG420-2A	—	—	CG560-2	—	—	—	—	—	CG560-3 (3)	CG560-4 (6)	CG560-5 (9)	—

*Included with hydraulic ram (see chart below).

6-ton Capacity (5.41 t), Tapped Hole

Set Stock No.	Hyd. Unit Ram Adapt.	Yoke	Pressure Screw	Centering Adaptor	Pressure Screw Adaptor	Thrust Nut Thrust Washer	Side Rods (2)	Side Rod Hex Nuts (6)	Clip/Washer	Side Rod Conn. Nuts (2)	End Blocks (2)	Side Rod Adaptors (2)	Cap Screw (2 ea)
CJ84C	—	CJ84-1B	CJ84-4	CJ84-16	—	—	5/8-18 x 10	—	ME5A16 (2)	—	—	—	—
CG706	—	CG656-2	CG706-1	C250-20	—	CG325-6, CG706-2	CG656-3 (4) (8")	CG656-7	CG656-8 (4)	CG656-6	CG656-6	CG656-12	—
CG710	—	CG150-2	CG710-1	CG270-20	CG710-3	CG45-2, CG710-2	CG150-3 (12"), CG150-4 (8")	—	—	—	CG150-6	—	—
CG656HY	CG654, CG656-9	CG656-2	—	—	CG656-13	—	CG656-3 (8")	CG656-7	CG656-8 (2)	CG656-5	CG656-6	CG656-12	CG656-11, CG656-10
CG656	—	CG656-2	—	—	CG656-13	—	CG656-3 (8")	CG656-7	CG656-8 (2)	CG656-5	CG656-6	CG656-12	CG656-11, CG656-10
CG150HY	CG122, CG150-9	CG150-2	—	*	CG150-12 (5/8"), CG150-13 (3/4")	—	CG150-3 (12"), CG150-4 (8")	—	—	CG150-6	—	CG150-11, CG150-10	—
CG150	—	CG150-2	—	—	CG150-12 (5/8"), CG150-13 (3/4")	—	CG150-3 (12"), CG150-4 (8")	—	—	CG150-6	—	CG150-11, CG150-10	—
CG450HYA	—	CG450-10	CG425-9	—	—	—	CG350-3 (18"), CG350-4 (9")	CG350-7	CG350-8 (2)	CG350-5	CG350-6	CG350-9	CG450-11, CG450-12
CG450	—	CG450-10	CG425-9	—	—	—	CG350-3 (18"), CG350-4 (9")	CG350-7	CG350-8 (2)	CG350-5	CG350-6	CG350-9	CG450-11, CG450-12
CG350	—	CG350-2	CG425-9	—	—	—	CG350-3 (18"), CG350-4 (9")	CG350-7	CG350-8 (2)	CG350-5	CG350-6	CG350-9	CG450-11, CG450-12
CG750HY	See Hyd. Unit Chart	CG750-2	—	—	CG750-11 (7/8"), CG750-13 (7/8")	—	CG750-3 (20"), CG750-4 (10")	CG750-7	CG750-8 (2)	CG750-5	CG750-6	CG750-9, CG750-10	CG750-11, CG750-12
CG750	CG720-9	CG750-2, CG550-2	—	—	CG750-14 (1-1/8")	—	CG750-3 (20"), CG550-3, CG750-4 (10")	CG750-7, CG550-7	CG750-8 (2)	CG350-5	CG750-6	CG750-9, CG750-10	CG750-11, CG550-10, CG750-12

*Included with hydraulic ram (see chart below).

Pump and Ram Sets

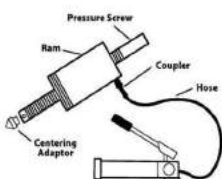

Stock No.	Capacity, tons	Ram	Included with Ram Pressure Screw	Included with Ram Centering Adaptor	Hose	Coupler	Pump	Optional Pressure Gauge	Items* Gauge Adaptor
CG222	4	CG220	CG220-13	—	CG120-3-1	CG120-4	CG4-2A	—	—
CG652	6	CG650	CG650-13	CG250-20	CG120-3-1	CG120-4	CG4-2A	CG420-6	CG420-5C
CG122	10	CG120	CG120-13	CG270-20	CG120-3-1	CG120-4	CG4-2A	CG420-6	CG420-5C
CG420A	20	CG420-1A	CG420-1-13A	CG420-1-14	CG420-3-1	CG420-4	CG420-2A	CG420-5C	CG420-6

*Standard with CG559 Bar-Style Puller Set.



PULLERS: BEARING SEPARATORS

Bearing Separators

Bearing separators. For separating and pulling double bearings and close fitting gears. Use with tapped hole, 2 jaw pullers or floor presses.

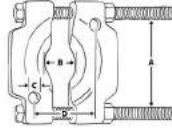

Stock No.	A	B	B	C	D
CJ949	1-11/16	1-1/8	1/4	5/16"-18	2-5/8
CJ950	2-3/8	2-3/8	3/8	3/8"-16	3-3/4
CJ951	4-3/8	4-1/2	5/8	5/8"-18	7-1/4
CJ952	5-7/8	6-1/8	1-1/2	5/8"-18	9-5/16
CJ953	8-3/8	8-3/4	1-1/4	7/8"-14	14-7/16



CJ950



CJ952

PULLERS: BAR-TYPE ADAPTORS

Male Adaptors

Stock No.	Female Thread	Male Thread
CG656-12	7/16"-14	5/8"-18
CG656-13	5/8"-11	5/8"-18
CJ84-6	5/8"-18	5/16"-24
CJ84-15	5/8"-18	5/16"-18
CJ84-7	5/8"-18	3/8"-24
CJ84-10	5/8"-18	3/8"-16
CJ84-8	5/8"-18	7/16"-20
CJ84-18	5/8"-18	7/16"-14
CJ84-9	5/8"-18	1/2"-20
CJ84-11	5/8"-18	1/2"-13
CJ84-17	5/8"-18	5/8"-18
CJ84-12	5/8"-18	5/8"-11
CJ84-13	5/8"-18	3/4"-16
CJ84-14	5/8"-18	3/4"-10
CG710-3	3/4"-16	5/8"-18
CG150-12	3/4"-10	5/8"-18
CG150-13	3/4"-10	3/4"-16
CG46-7*	3/4"-10	1"-14
CG46-8**	3/4"-16	1"-14
CG750-9	1"-14	3/4"-16
CG750-10	1"-14	7/8"-14
CG455-18	1-1/8"-8	5/8"-18
CG455-19	1-1/8"-8	7/8"-14
CG47-420	1-1/8"-8	1-1/4"-12
CG550-9	1-3/8"-6	1-3/4"-12
CG455-1	7/8"-14	5/8"-18
CG455-2	7/8"-14	5/8"-11
CG455-3	7/8"-14	3/4"-16
CG455-4	7/8"-14	7/8"-10
CG455-5	7/8"-14	7/8"-9
CG455-6	7/8"-14	1"-14
CG455-7	7/8"-14	1"-8
CG455-8	7/8"-14	1-1/8"-12

*For attaching CG46 Series Pullers to CG105HY Hydraulic Bar-Style Puller.
**For attaching CG46 Series Pullers to CG710 Push/Pull Set.

CG455 16 pc Male Adaptor Set

- Includes (16 pc) two each of the male adaptors CG455-1–CG455-8



CG455



CG455A

Female Adaptors

Stock No.	Female Thread
CG455-9	7/8"-14 and 5/8"-18
CG455-10	7/8"-14 and 3/4"-16
CG455-11	7/8"-14 and 1"-14
CG455-12	7/8"-14 and 1-1/8"-8
CG455-13	7/8"-14 and 1-1/8"-12
CG455-14	7/8"-14 and 1-1/4"-8
CG455-15	7/8"-14 and 1-1/4"-12
CG455-17	7/8"-14 and 1-1/2"-12
CG455-16	7/8"-14 and 1-1/2"-8

CG455A 18 pc Female Adaptor Set

- (18 pc) two each of the female adaptors



- Screen the puller application
- Inspect the puller, do not use damaged parts
- Use the proper type and size puller for the job
- Read safety precautions on pages W1 to W4

PULLERS: BLIND HOLE BEARING

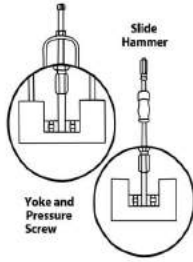

CG40CB

Stock No.	Description	Internal Thread Size	External Thread Size
CG40-1	Pressure Screw	—	—
CG40-2	15/16" Nut	—	—
CG40-3	3 1/4" spread Yoke	—	—
CG41-11	Expanding Rod	5/8-18	3/8-24
CG41-14	1/4-5/16" Collet	—	—
CG41-12	5/16-3/8" Collet	—	—
CG41-13	3/8-7/16" Collet	—	—
CG40-4	1/2-20 Expanding Rod	5/8-18	1/2-20
CG40-9	7/16-1/2" Collet	—	—
CG40-15	1/2"-5/8" Collet	—	—
CG40A6	5/8-3/4" Collet	—	—
CG40-7	3/4-7/8" Collet	—	—
CG40-8	7/8-1" Collet	—	—
CG40A10	1-1-1/8" Collet	—	—

CG40CB 14 pc Blind Hole Bearing Puller Set

- (14 pc) collets, yoke, pressure screw and expanding rods
- Range 1/4-1-1/8"
- Includes storage box



CG45

Stock No.	Description	Internal Thread Size	External Thread Size
CG270-1A	Pressure Screw	—	—
CG45-2	1-1/8" Wrench Size Thrust Nut	—	—
CG45-3	5-3/4" spread Yoke	—	—
CG45-4	Expanding Rod	3/4-16	5/8-18
CG45-15	1-1-1/4" Collet	—	—
CG45-6	1-1/4-1-1/2"	—	—
CG45-7	1-1/2-1-3/4" (Uses CG45-4 Expanding Rod) Collet	—	—

CG45 7 pc Blind Hole Bearing Puller Set

- Includes (7 pc) (1-1-3/4") collets, yoke, slide screw and slide hammer



CG2545AB

Stock No.	Description	Internal Thread Size	External Thread Size
CG250-8A	5/8"-18 UNF x 18 9/16" Slide Screw	—	—
CG250-9	2 lb Slide Hammer	—	—
CG40-1	Pressure Screw	—	—
CG40-2	15/16" Nut	—	—
CG40-3	3 1/4" spread Yoke	—	—
CG41-11	Expanding Rod	5/8-18	3/8-24
CG41-14	1/4-5/16" Collet	—	—
CG41-12	5/16-3/8" Collet	—	—
CG41-13	3/8-7/16" Collet	—	—
CG40-4	1/2-20 Expanding Rod	5/8-18	1/2-20
CG40-9	7/16-1/2" Collet	—	—
CG40-15	1/2"-5/8" Collet	—	—
CG40A6	5/8-3/4" Collet	—	—
CG40-7	3/4-7/8" Collet	—	—
CG40-8	7/8-1" Collet	—	—
CG40A10	1-1-1/8" Collet	—	—
CG270-1A	Pressure Screw	—	—
CG45-2	1-1/8" Wrench Size Thrust Nut	—	—
CG45-3	5-3/4" Spread Yoke	—	—
CG45-4	Expanding Rod	3/4-16	5/8-18
CG45-15	1-1-1/4" Collet	—	—
CG45-6	1-1/4-1-1/2"	—	—
CG45-7	1-1/2-1-3/4" (Uses CG45-4 Expanding Rod) Collet	—	—

CG2545AB 25 pc Blind Hole Bearing Puller Set

- Includes (25 pc) collets, yokes, slide screw and slide hammer

CG46

Stock No.	Description	Internal Thread Size	External Thread Size
CG46-1	1"-14 x 18" Slide Screw	—	—
CG46-2	6 lb Slide Hammer	—	—
CG46-3	Expanding Rod	1-14	1-1/8-12
CG46-4	1 5/8-2" (Uses CG46-4 Expanding Rod) Collet	—	—
CG46-5	2-2-1/2" (Uses CG46-4 Expanding Rod) Collet	—	—
CG46-6	2 1/2-3" (Uses CG46-4 Expanding Rod) Collet	—	—

CG46 6 pc Blind Hole Bearing Puller Set

- Includes (3) collets, slide screw, slide hammer and expanding rod
- For large size blind hole bearings, Torrington® needle bearings, heavy-duty bearings on live center lathes, conveyor belts and rollers

CG47

Stock No.	Description	Internal Thread Size	External Thread Size
CG4567N	11/4"-12 x 24" Slide Screw	—	—
CG4567O	10 lb Slide Hammer	—	—
CG47-201	Expanding Rod	1-1/4-12	1-1/8-12
CG47-202	Master Collet	—	—
CG47-203	3-3- 1/2" (Uses CG47-201 Expanding Rod) Collet Pad	—	—
CG47-204	3-1/2-4" (Uses CG47-201 Expanding Rod) Collet Pad	—	—
CG47-205	4-4-1/2" (Uses CG47-201 Expanding Rod) Collet Pad	—	—
CG47-206	3-1/2-5" (Uses CG47-201 Expanding Rod) Collet Pad	—	—
CG47-207	5- 5-1/2" (Uses CG47-201 Expanding Rod) Collet Pad	—	—
CG47-208	5-1/2-6" (Uses CG47-201 Expanding Rod) Collet Pad	—	—
CG47-209	6-6-1/2" (Uses CG47-201 Expanding Rod) Collet Pad	—	—
CG47-210	6-1/2-7" (Uses CG47-201 Expanding Rod) Collet Pad	—	—
CG47-211	3/4" Screw	—	—
CG47-212	1-3/4" Screw	—	—

CG47 13 pc Blind Hole Bearing Puller Set

- Includes (13 pc) master collet, pads, slide screw and slide hammer
- Pulling size is changed by changing pads

Accessories
CG40-11 43/64-53/64" Collet

- For needle bearings on Leece-Neville® alternators
- Use with CG40-4 expanding rod

CG40-12 15-18 mm Collet

- For pilot bearings on late model Ford® transmissions
- Use with CG40-4 expanding rod

CG40-4-1 4" Collet Extension

- For CG40 series collets

CG46-8 Male Adaptor

- Female thread 3/4"-16
- Male thread 1"-14
- For attaching CG46 series pullers to CG710 push/pull set

CG46-7 Male Adaptor

- Female thread 3/4"-10
- Male thread 1"-14
- For attaching CG46 series pullers to CG105HY hydraulic bar style puller

CG47-420 Male Adaptor

- Female thread 1-1/8"-8
- Male thread 1-1/4"-12
- For attaching CG47 series pullers to CG450HYA hydraulic bar style puller

CJ105-4B Slide Screw

- Included with CJ2003A rear axle puller set
- 3/4"-16 x 22-1/2"

CJ97-3A 3-3/4 lb Slide Hammer

- Included with CJ2003A rear axle puller set



- Screen the puller application
- Inspect the puller, do not use damaged parts
- Use the proper type and size puller for the job
- Read safety precautions on pages W1 to W4