



# Conference Systems





## Wired or Wireless Units for System Flexibility

### TS-910 Series



#### System Benefits

- No worries about radio interference, eavesdropping, or information leakage, thanks to wireless system's IR communication method.
- Versatile Cat 5 cable connection available for wired units.
- Suitable for either permanent or temporary installation.
- Failure in one terminal unit does not affect other units.
- System can be controlled by external equipment via RS-232C and USB port.
- Individual control of units possible by assigning unit addresses.
- Exceptional sound quality.
- Connect a recording device for high-quality audio recording of conferences.
- Triple choice vote function.
- Bilingual conference capability.
- Built-in feedback suppressor for more efficient reduction of acoustic feedback.
- Stable and stylish hardware design.
- When speaker is on, chairman/delegate unit mic is turned off automatically to avoid feedback, and vice versa.
- Management & Voting Software compatibility

#### System Example

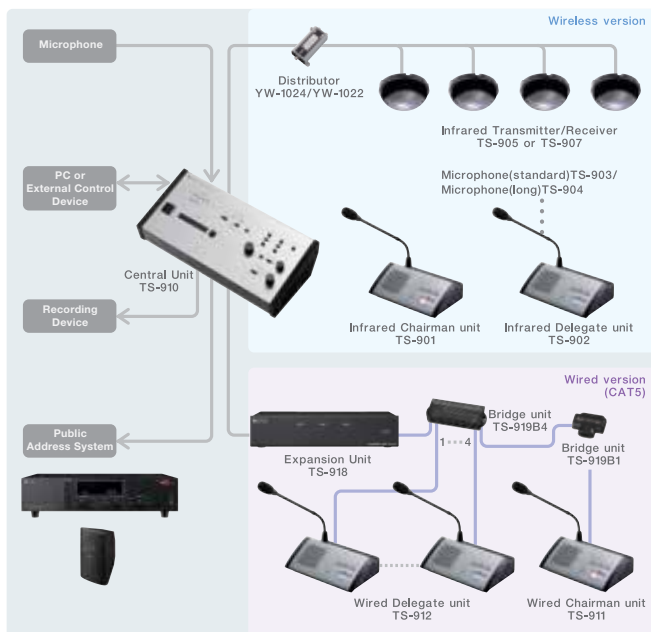

## Easy Cable-Free Installation

### TS-800 Series



#### System Benefits

- Flexible and easy configuration in different rooms and with varied participant numbers.
- No worries about radio interference, eavesdropping, or information leakage thanks to IR communication method.
- Suitable for either permanent or temporary installation.
- System can be controlled by external equipment via RS-232C.
- Individual control of units possible by assigning unit addresses.
- Exceptional sound quality.
- Connect a recording device for high-quality audio recording of conferences.
- Stable and stylish hardware design.
- When speaker is on, chairman/delegate unit mic is turned off automatically to avoid feedback, and vice versa.

#### System Example

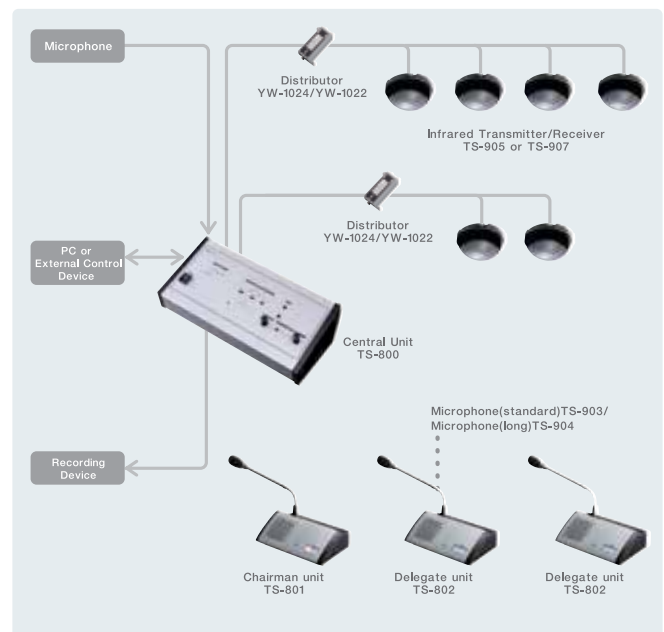

## Built-in MP3 Recorder for Quick Conference Recording

### TS-780 Series



#### System Benefits

- Plug-and-play system.
- Up to 64 units can be attached to a single Central Unit.
- System expandable to 192 units by connection of 3 Central Units.
- Test function allows connections to be accurately verified.
- Conferences can be recorded onto SD card or external recording device.
- Built-in feedback suppressor for more efficient reduction of acoustic feedback.
- External equalizing capability.
- Compact and stable hardware design.

#### System Example

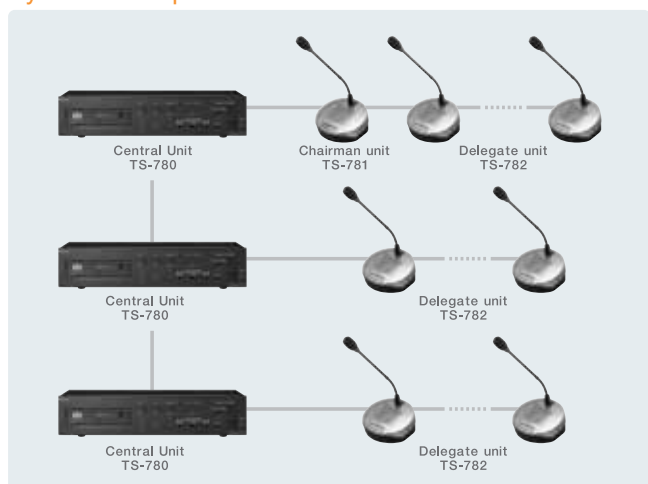

## Simple and Compact Wired Conference System

### TS-680 Series



#### System Benefits

- Plug-and-play system.
- Up to 24 units can be connected per Central Unit.
- Suitable for small-scale corporate boardrooms and meeting rooms.
- Test function allows connections to be accurately verified.
- Connect a recording device for high-quality audio recording of conferences.
- Compact and stable hardware design.
- Both Chairman and Delegate unit comes with a long microphone as a standard accessory.

#### System Example

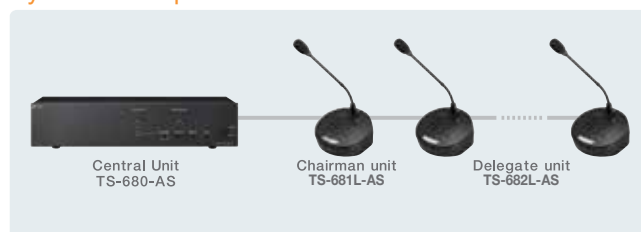

## Other System Components

### TS-910 Series

Bridge Unit  
TS-919B1



TS-919B4



Expansion Unit  
TS-918



### TS-780/680 Series

Microphone

TS-773



TS-774

Extension Cord

YR-780-2M



YR-780-10M



### TS-910/800 Series

Microphone

TS-903



TS-904



Infrared Transmitter / Receiver

TS-905

Ceiling height: 2.5 - 4.5m



TS-907

Ceiling height: 5 - 7m



Rechargeable Lithium-ion Battery  
BP-900



Distributor

YW-1022

(to 2 outputs)



YW-1024

(to 4 outputs)



Rack Mount Bracket

MB-TS900



Battery Charger

BC-900



AC Adapter

AD-0910



TS-910 Central Unit		TS-800 Central Unit	
Input	2 x Mic: -60dB*, 600 ohms, unbalanced, phone jack 3 x AUX: -20 dB*, 10k ohms, unbalanced, phone jack	1 x Mic: -60dB*, 600 ohms, unbalanced, phone jack 1 x AUX: -20 dB*, 10k ohms, unbalanced, phone jack	
Output	1 x Line: -20dB*, unbalanced, phone jack 2 x Recording: -20dB*, 10k ohms, unbalanced, phone jack/RCA pin jack 1 x Headphone: mini jack	2 x Recording: -20dB*, 10k ohms, unbalanced, phone jack/RCA pin jack 1 x Headphone: mini jack	
External EQ	Input: -20dB*, 10k ohms, RCA pin jack Output: -20dB*, 10k ohms, RCA pin jack	- -	
No. of connectable Chairman/Delegate Unit	192	64	
External Control Terminal	D-sub connector (9P, male)/USB-B selectable	D-sub connector (9P, male)	
Function Switch	Speaker restriction: set to 1,2,3 and 4 Mic-off function: off or on (selectable) Speech priority selector A/B/C A: First-in-first-out, B: Last-in-first-out, C: Fixed for the first unit and last-in-last out for the subsequent units FBS selection: External/Off/Auto/Manual	Speaker restriction: set to 1,2 and 4 Mic-off function: off or on (selectable) Speech priority selector A/B/C A: First-in-first-out, B: Last-in-first-out, C: Fixed for the first unit and last-in-last out for the subsequent units	
Applicable Unit	TS-901/902/911/912, TS-801/802/811/812	TS-801/802	
Dimensions	359(W) x 118.8(H) x 179.8(D) mm (14.13" x 4.68" x 7.08")	359(W) x 118.8(H) x 179.8(D) mm (14.13" x 4.68" x 7.08")	
Weight	2.8 kg (6.17 lb)	2.7 kg (5.95 lb)	

TS-901 Chairman Unit	TS-902 Delegate Unit	TS-801 Chairman Unit	TS-802 Delegate Unit	TS-911 Chairman Unit	TS-912 Delegate Unit	TS-811 Chairman Unit	TS-812 Delegate Unit
Power Source				24V DC (supplied from the optional TS-918 Expansion Unit)			
Input				Microphone terminal: XLR-4-31 type			
Output				Monitor speaker: 8 ohms, 0.2W Headphone: Mini jack x 2			
Battery Life				Approx. 10 hours			
Connection Terminal				RJ45 connector			
Function	Monitor speaker volume Headphone volume Priority speech function Voting function Monitor selector switch	Monitor speaker volume Headphone volume Voting function Monitor selector switch	Monitor speaker volume Headphone volume Priority speech function	Monitor speaker volume Headphone volume	Monitor speaker volume Headphone volume Priority speech function Voting function Monitor selector switch	Monitor speaker volume Headphone volume Voting function Monitor selector switch	Monitor speaker volume Headphone volume Priority speech function Headphone volume
Dimensions	210(W) x 65.9(H) x 152(D) mm (8.27" x 2.59" x 5.98")						
Weight	640g (1.41 lb)						

TS-780 Central Unit		TS-680-AS Central Unit	
Input	1 x Mic: -60dB*, 600 ohms, unbalanced, phone jack 1 x AUX: -20 dB*, 10k ohms, unbalanced, phone jack	1 x Mic: -60dB*, 600 ohms, unbalanced, phone jack 1 x AUX: -20 dB*, 10k ohms, unbalanced, phone jack	
Output	3 x Recording: -20dB*, 10k ohms, unbalanced, phone jack/RCA pin jack x 2 1 x Headphone: mini jack	1 x Recording: -20dB*, 10k ohms, unbalanced, RCA pin jack	
External EQ	Input: -20dB*, 10k ohms, RCA pin jack Output: -20dB*, 10k ohms, RCA pin jack	- -	
No. of connectable Chairman/Delegate Unit	192	24	
Function Switch	Speaker restriction: Delegate unit's simultaneous operation set to 0,1,2,3 and 4 Mic-off function: off or 30 sec. (selectable) FBS selection: External/Off/Auto/Manual MP3 recording and playback	Speaker restriction: Delegate unit's simultaneous operation set to 0, 1, 2 and 3 Mic-off function: off or 30 sec. (selectable)	
Applicable Unit	TS-781/782	TS-681L-AS/682L-AS	
Dimensions	420(W) x 96.1 (H) x 226.2(D) mm (16.54" x 3.78" x 8.91")	420(W) x 96.1 (H) x 222.5(D) mm (16.54" x 3.78" x 8.76")	
Weight	3 kg (6.61 lb)	2.7 kg (5.95 lb)	

TS-781 Chairman Unit	TS-782 Delegate Unit	TS-681L-AS Chairman Unit	TS-682L-AS Delegate Unit
Power Source		36V DC (supplied from TS-680-AS Central Unit)	
Input		Microphone terminal: XLR-4-31 type	
Output		Monitor speaker: 130 ohms, 200 mW Headphone/Recording: Mini jack x 1	
Microphone Unit		Electret condenser microphone	
Connection Terminal		DIN 8P connector	
Function	Monitor speaker volume Headphone volume Priority speech function	Monitor speaker volume Headphone volume	Monitor speaker volume Headphone volume Priority speech function
Dimensions	145.3 (W) x 70.7 (H) x 150.5(D) mm (5.72" x 2.78" x 5.93")		
Weight	800 g (1.76 lb)		

Other System Components		
TS-910 Series	TS-918 Expansion Unit	
	TS-919B4 Bridge Unit	
	TS-919B1 Bridge Unit	
	MB-15B-BK Rack Mount Bracket	Bracket for TS-918
TS-910/800 Series	MB-15B-J Rack Mount Bracket	Bracket for TS-918
	TS-903 Microphone	368 mm (1.21ft) length
	TS-904 Microphone	518 mm (1.7ft) length
	TS-905 Infrared Transmitter/Receiver	150 (vert.) x 360 (hor.) reception angle
	TS-907 Infrared Transmitter/Receiver	90 (vert. ) x 360 (hor.) reception angle
	BP-900 Rechargeable Lithium-ion Battery	
	BC-900 Battery Charger	
	AD-0910 AC Adapter	
	YW-1022 Distributor	to 2 outputs
	YW-1024 Distributor	to 4 outputs
MB-TS900 Rack Mount Bracket	Bracket for TS-910/800	

Software Components (Optional)	
TS-910 Series	Management & Voting Software (not included)

Other System Components		
TS-780 Series	TS-773 Microphone	368 mm (1.21ft) length
	TS-774 Microphone	518 mm (1.7ft) length
TS-780/680 Series	YR-780-2M Extension Cord	2 m (6.56ft) length
	YR-780-10M Extension Cord	10 m (32.81ft) length
	MB-23B Rack Mount Bracket	Bracket for TS-780 and TS-680-AS



Like us on Facebook  
facebook.com/TOAasiapacific

TOA Electronics Pte Ltd  
www.toa.com.sg

Specifications are subject to change without notice.  
Printed in Singapore (65) 865-0616-01A